

Exercícios de montagem – 16/04/09

1. Montar o conjunto Vela - castiçal

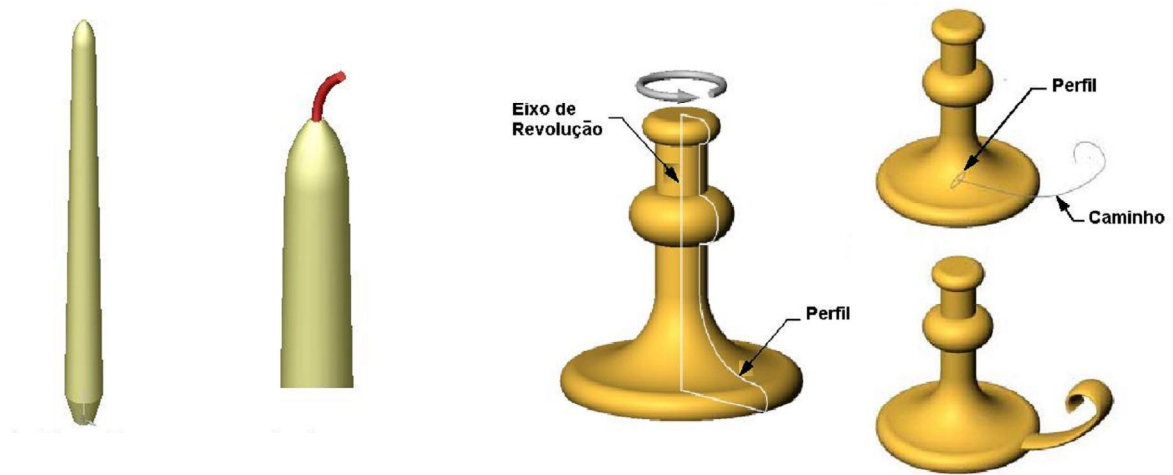

2. Exercitar a montagem da morsa

3. Estudar a montagem da fonte de alimentação: ver componentes inseridos e posicionamentos

4. Grampo em “C”: modelar, detalhar componentes, montar e gerar vista explodida

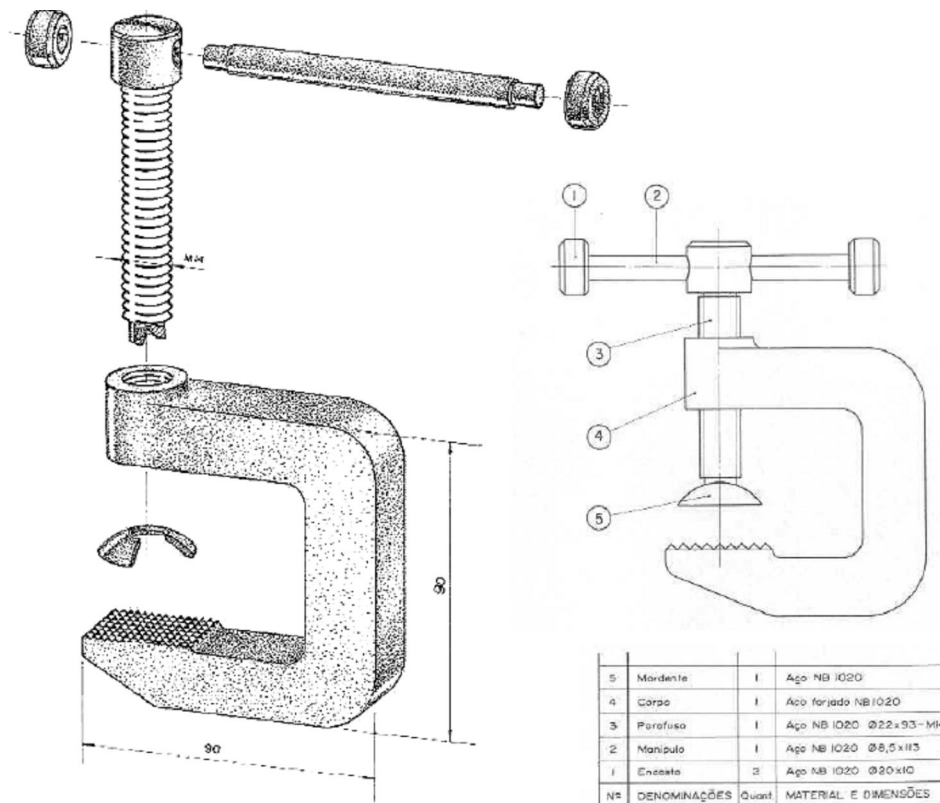

1

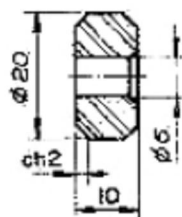

2

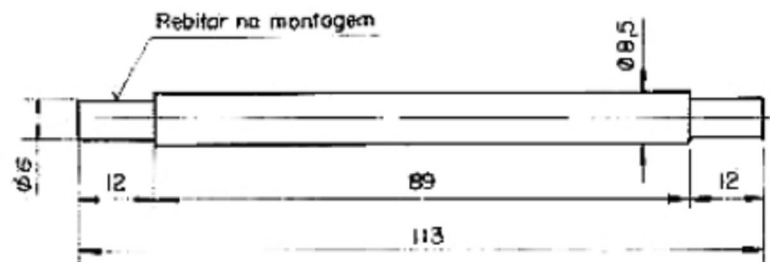

3

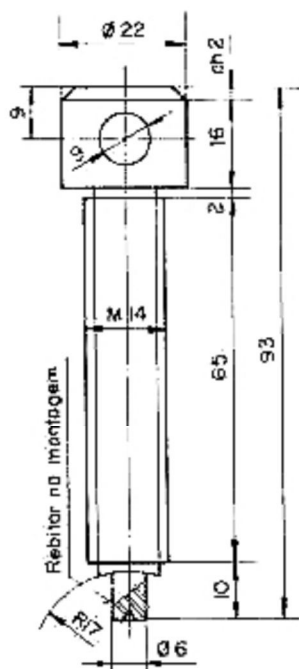

4

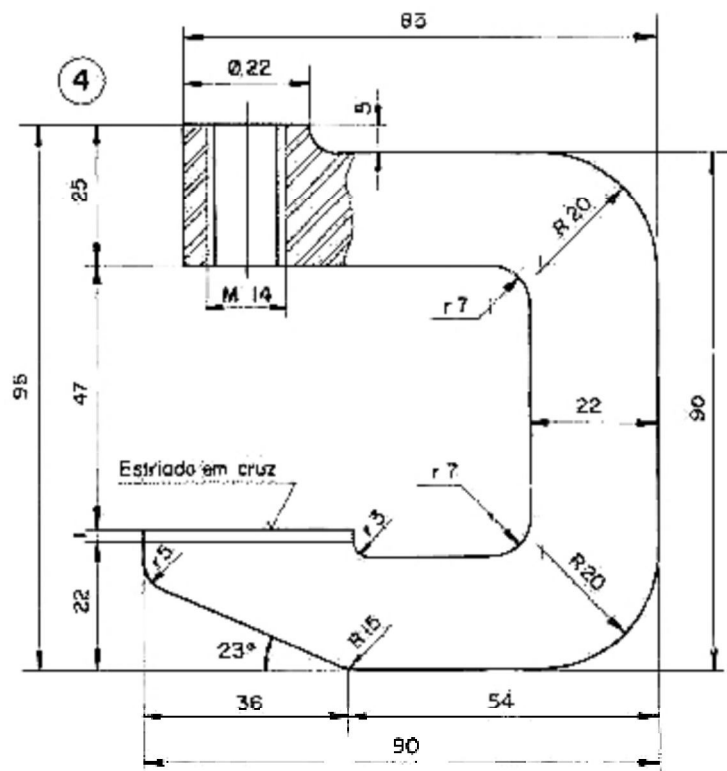

5

